

# APPLYING TO RESIDENCE





# WHERE **CAMPUS** COMES TO **LIFE**

## Congratulations!

You've made a big decision to accept your offer to the University of Guelph. We look forward to having you join us in our residence communities this fall!

Living on campus is an essential part of the Gryphon experience. Residence provides an environment to foster relationships, gain independence, and promote your academic success.

Now, let us help you get started. This guide provides an overview of our unique communities, the application process, and what to expect on the first steps of your journey.

Explore our website, browse @UofGHousing on social media, and connect with us if you have any questions. See you soon, #FutureGryphon!

## IMPORTANT DATES

### **June 1, 2023**

Residence Application AND \$750 Deposit Due

### **June 1, 2023**

Accommodation Request Form Due (If Applicable)

### **July 15, 2023**

Deadline to Cancel Contract for \$500 Refund

### **Late July**

Room Assignments Released

### **August 31 - September 2, 2023**

Residence Move-In

### **September 7, 2023**

First Day of Classes

# RESIDENCE PRIORITY

[housing.uoguelph.ca/priority](https://housing.uoguelph.ca/priority)

We are confident that the University will be able to offer on-campus housing to first-year students who apply and pay their residence deposit by the June 1, 2023, deadline.

**First-year international students as well as first-year Canadian students who reside outside of Ontario are guaranteed on-campus housing as long as they apply and pay the residence deposit by June 1, 2023.**

For all other first-year students, if demand exceeds supply, a lottery system will be used to allocate spaces. Students will be advised by June 9th, 2023, if they have received a space in residence.

## HOW WE DO ROOM ASSIGNMENTS

[housing.uoguelph.ca/assignments](https://housing.uoguelph.ca/assignments)

The University of Guelph uses a lottery system to complete room assignments. All first-year, incoming students with an offer of residence will receive a randomly-generated lottery number.

Preferences for room assignments must be indicated on your application form, including your preferred room and building type, and any residence learning communities of interest.

**Although over 85% of first-year students typically receive at least one of their requests, your assignment location is not guaranteed.** You are encouraged to include variety in your application in case your top preferences are no longer available when your lottery number is reached.





# OUR COMMUNITIES

East Residence  
Single Room

Like our #FutureGryphons, each residence is unique.

At the University of Guelph, we have 12 residence buildings that accommodate over 4,700 students. Our mix of traditional, apartment, suite, and townhouse-style residences means we have a living environment to match your unique needs and lifestyle.

Learn more about each residence by visiting [housing.uoguelph.ca/explore](https://housing.uoguelph.ca/explore).

	Building	Campus Area	Style <sup>1</sup>	Co-Ed <sup>2</sup>	Built	Spaces <sup>3</sup>	Room Types <sup>3</sup>
SOUTH	Mountain Hall	South	Traditional	Co-ed	1970	608	① ② ③ ④
	Prairie Hall	South	Traditional	Co-ed	1970	608	① ② ③ ④
	Maritime Hall	South	Traditional	Co-ed	1970	608	① ② ③ ④
NORTH	Johnston Hall	North	Traditional	Co-ed	1931	320	① ② ③
	Arts House	North	Traditional	Co-ed	1914	50	②
	Mills Hall	North	Traditional	Co-ed	1921	195	① ③ ④
	Lambton Hall	North	Suites & Traditional	Co-ed	1966	385	① ②
	Lennox & Addington	North	Traditional	Co-ed	1971	575	① ②
	Watson Hall	North	Traditional	Female	1931	50	②
EAST	Dundas Hall	East	Suites	Co-ed	1972	134	① ②
	Glengarry Hall	East	Suites	Co-ed	1972	344	① ②
	Lanark Hall	East	Suites	Co-ed	1972	133	① ②
	Village Townhouses	East	Townhouse	Co-ed	2001	200	① ②

Room Types:      ① = Single      ② = Double      ③ = Triple      ④ = Quad

Notes:

1. A traditional residence consists of a student room, with a shared community washroom, kitchenette and common space. A suite consists of a single or double bedroom with a shared bathroom and kitchenette (Lambton) or full kitchen (East) with microwave (Lambton) or full stove (East), sink and fridge.
2. Single gender, gender-neutral and co-ed areas can be assigned within residence communities.
3. Building capacity and room types are subject to change from year to year based on occupancy needs.

# WHICH RESIDENCE IS THE BEST?

Living in residence is so much more than a room with a bed. Being ranked #1 in Canada for Residence Living\*, we foster tight-knit communities through enhanced programming, academic support, and resources to support your success. Typically, the best residence is the one you're assigned to, as you establish roots and make connections in your community.

**When selecting preferences for your Residence Application, it's important to ask yourself a few important questions:**

- Do I want to live in a traditional, suite-style, or townhouse residence?
- Do I want a meal plan or a full kitchen with an optional meal plan?
- Do I study better in a quiet living environment, or am I motivated by having lots of activity around me?
- Do I want to live in a single-gender or co-ed community?
- Do I want to live with other students in the same academic program or who share common interests?
- Do I want to live with a roommate or prioritize a single room?
- Do I have a preferred roommate(s)?

## LOOKING FOR MORE INSPIRATION?

Visit our social media highlights for full residence walk-throughs and more details.

**Follow @UofGHousing for more!**

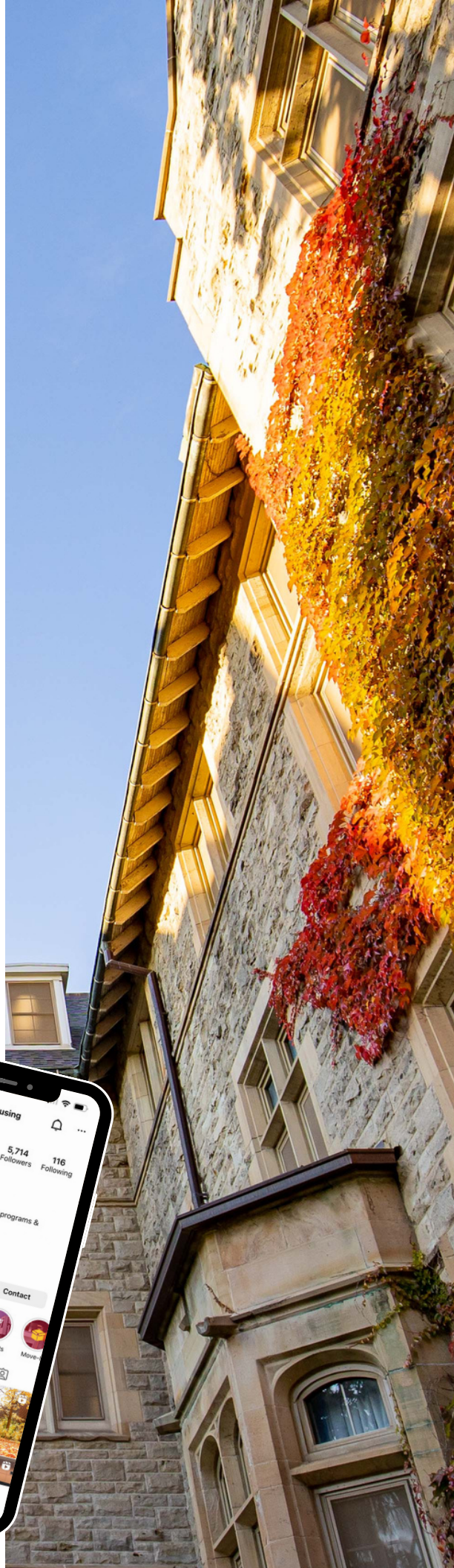
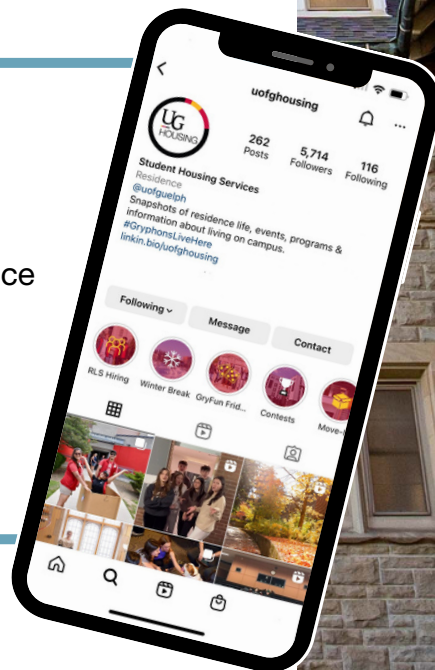

# SOUTH RESIDENCE

**South Residence** is our largest community, housing approximately 1,800 students in three buildings: **Mountain, Prairie and Maritime Halls**.

Designed by world-renowned modern architect John Andrews, residents enjoy an inter-connected complex with two dining halls, TV lounges, kitchenettes, and academic drop-in centres.



## South Residence

offers the following room types:

- South Single
- South Double
- South Triple
- South Quad
- South 3-bedroom apartment

## Features:

- 24-hour service desk in Prairie Hall
- Fully furnished rooms with twin bed, dresser/wardrobe, desk, chair, lamp, and bulletin board
- Two on-site dining locations in Prairie and Mountain Hall
- On-site laundry facilities
- Large TV lounges
- Group study space
- Games room with a pool table and ping pong

This is a  
**SOUTH SINGLE.**  
More than 2,000  
single rooms are  
available for first year  
students across  
campus.



# South Residence is a network of communities.

## Mountain Hall

Woodlands  
Glacier  
Foothills  
Valley

## Prairie Hall

Homestead  
Tundra  
Grasslands  
Horizon

## Maritime Hall

Harbour  
Schooner  
Seaway  
Cove

A **South Corridor Double** room features expansive windows for natural light and large storage closets.



A **South Alcove Single** room offers privacy, a window nook and loads of storage space.

This is a **SOUTH TOWER LOUNGE.**

Watch a movie or stream the game with friends!

Disclaimer: All room layouts shown in this booklet are representative examples. Layout and furnishings may vary.





# NORTH RESIDENCES

---

Lennox & Addington Hall  
Lambton Hall  
Johnston Hall  
Mills Hall  
Watson Hall  
Maids Hall

## Features:

- 24-hour service desk located in Lennox & Addington Hall
- Fully furnished rooms with standard twin bed, dresser/wardrobe, desk, chair, lamp, mirror and bulletin board
- On-site dining hall in Lennox & Addington, with close proximity to Creelman Dining Hall
- Lennox-C is home to a Study-Intensive community
- Arts House is located in Maids Hall
- Academic Drop-In Centre located in Lennox & Addington Hall

This is  
**ADDINGTON.**  
Ten stories tall, it is  
connected to  
Lennox Hall to form  
one cohesive  
community.



# Lennox & Addington Halls



North Single Room



North Double Room

## Features:

- Dining hall, Starbucks, and Residence desk within the building
- On-site Academic Drop-In Centre for independent and group study
- TV lounge with a communal kitchen
- Laundry facilities (included)
- Hockey, bike, and large equipment storage

Lennox & Addington offer the following room types:

North Single  
North Double

Lennox and Addington includes **STARBUCKS** and a dining hall within the building, a perfect spot to study.

Disclaimer: All room layouts shown in this booklet are representative examples. Layout and furnishings may vary.



# Lambton Hall

## Features:

- Large study room for independent work
- TV lounge with a communal kitchen
- A fireplace lounge which includes ping pong and a pool table
- Laundry facilities (included)
- Hockey, bike, and large equipment storage



A **Lambton Double Suite** includes two single rooms with a shared ensuite and kitchenette.



Lambton  
Double

## Lambton Hall

offers the following room types:

- North Single
- North Double
- North Double Suite

## ALL RESIDENCE FURNITURE

is moveable so that you can set up your room according to your needs.



# Watson Hall



Watson **Double Rooms** feature large windows and closets.

## Watson Hall

offers the following room types:

North Double

## Features:

- All-female residence
- Nestled on the edge of scenic naturalized greenspace
- A communal kitchen and large lounge space
- Music and study room
- Laundry facilities (included)

This is a **WATSON DOUBLE**,  
An all-female community where lifelong friendships begin.



# Mills Hall

## Features:

- Large main floor fireplace lounge and smaller floor lounges
- Centrally located across from Creelman Dining Hall
- Triple and quad rooms feature moveable lofted furniture and large, bright windows
- Laundry facilities (included)
- Music room and study space

## Mills Hall

offers the following room types:

North Single

North Triple

North Quad



**Mills Quad Rooms**  
feature lofted furnishings  
and large bright windows

Mills Hall  
is across from  
**CREELMAN HALL,**  
the crown jewel of  
dining on campus!

Disclaimer: All room layouts shown in this booklet are representative examples. Layout and furnishings may vary.

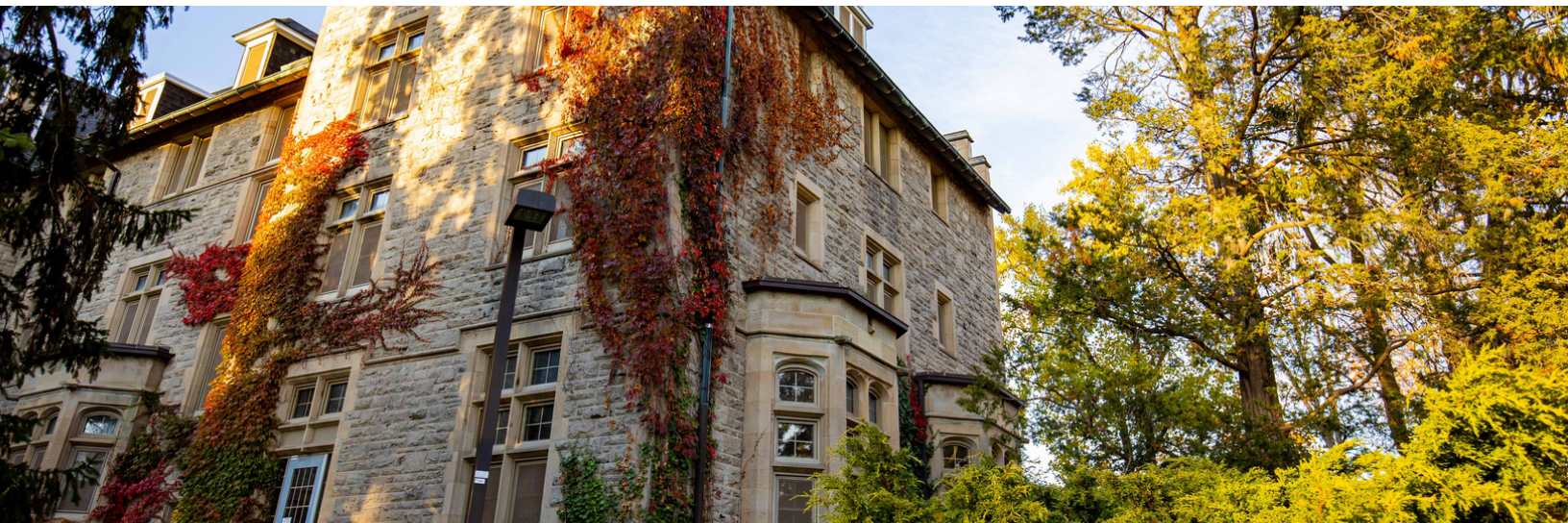

# Johnston Hall

## Features:

- Centrally located beside Creelman Hall
- Common lounges on each floor with kitchenettes
- Large games room lounge with pool, ping pong, communal kitchen, and a spiral staircase
- Laundry facilities (included)
- Hockey and large equipment storage room

## Johnston Hall

offers the following room types:

Johnston Single  
Johnston Double  
Johnston Triple

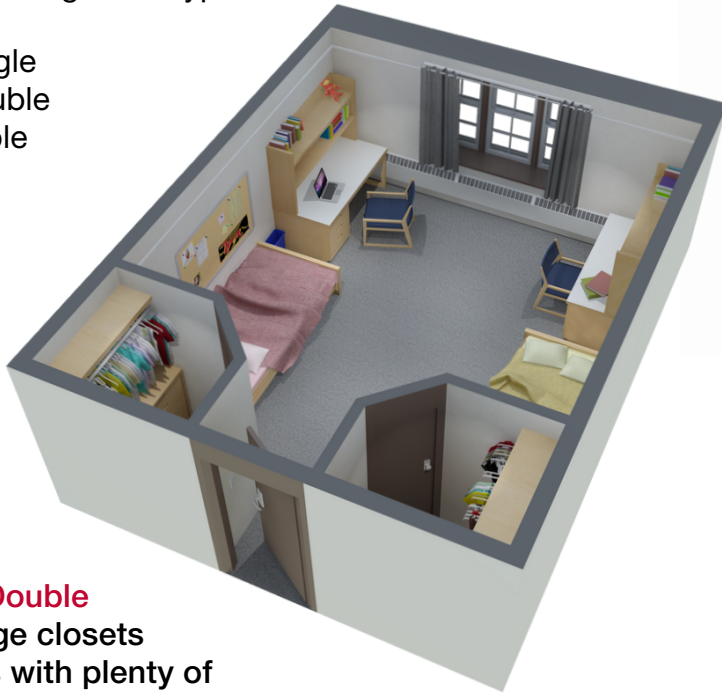

A **Johnston Double** room has large closets and windows with plenty of space to move around.

A **Johnston Single** room has loads of storage space and natural light. All furnishings are moveable.

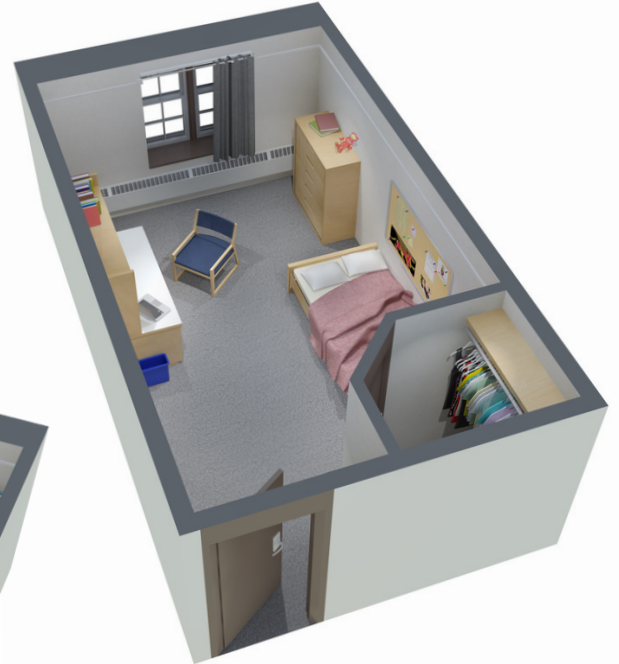

This is a  
**JOHNSTON  
TRIPLE.**

Johnston's beautiful stone architecture makes it a must-see spot on campus.



# Arts House

(Maids Hall)

## Features:

- Fully furnished rooms with walk-in closets and a traditional feel
- Laundry facilities (included), music room and study space
- Kitchen and common lounge

## Arts House

offers the following room types:

North Double



Arts House **Double Rooms** feature large closets and plenty of space to study.



This is a  
**LIVING LEARNING  
COMMUNITY.**

Live with other  
students that share  
similar interests!



# EAST RESIDENCES

---

Glengarry Hall  
Lanark Hall  
Dundas Hall  
East Village Townhouses

## Features:

- 24-hour service desk located in Dundas Hall
- Fully furnished rooms with standard twin bed, dresser/wardrobe, desk, chair, lamp, mirror and bulletin board
- On-site convenience store with grocery and grab-and-go items
- Dundas Hall is home to the Living Learning Communities and a substance-free area
- East Village is home to a Study-Intensive community
- Academic Drop-In Centre located in Glengarry Hall
- Close proximity to the new Gryphon Athletic Centre and University of Guelph Arboretum

At 12 stories  
in height,  
**GLENGARRY  
HALL**  
is the tallest building  
on the U of G  
campus!



# East Residence

## East Residence

offers the following room types:

East Single  
East Double

## Features

- Three linked buildings with suites of 6, 8 or 12 students
- Full kitchens with a stove, fridge, sink and dining area
- Living room with couches and coffee table
- Laundry facilities (included)
- Fireplace lounge and TV lounge
- Access to the same services and supports of traditional residences.
- Hockey, bike, and large equipment storage room

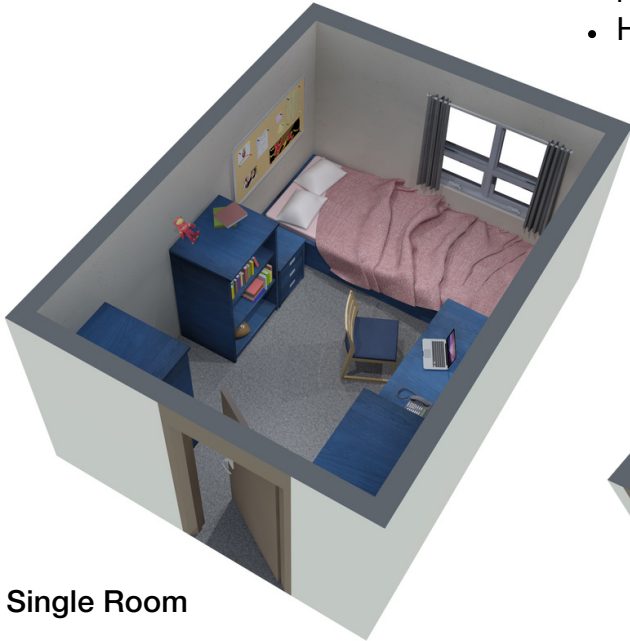

East Single Room



East Double Room

East Residence  
is home to  
**EASTSIDE  
VARIETY.**

Perfect to grab an  
ingredient for dinner  
or a late-night  
snack.

Disclaimer: All room layouts shown in this booklet are representative examples. Layout and furnishings may vary.





# East Village Townhouses

## Features

- Independent living with 4, 5 or 6 bedrooms. Choose your suitemates or let us match you.
- Full kitchens with stove, fridge, sink and dining area with table and chairs
- Living room with couch and coffee table
- A low washroom ratio with 2-3 students sharing per floor
- Access to the same services and supports as traditional residences.
- Town hall with laundry facilities (included) and games room

## East Village Townhouses

offer the following rooms types:

Village Single  
Village Double

### *Looking for a cost-effective residence option?*

East Village double rooms offer the amenities of a townhouse with an optional meal plan and the price of a traditional double residence room.

East Village  
**First Floor**



East Village  
**Second and Third Floors**  
feature two bedrooms with a shared washroom.

This is an  
**EAST VILLAGE SINGLE ROOM,**  
complete with plenty of storage and an oversized desk!



# ENHANCE YOUR EXPERIENCE

[housing.uoguelph.ca/enhance](https://housing.uoguelph.ca/enhance)

At the University of Guelph, we strive to enhance every student's residence experience by offering you opportunities to make your residence environment more than just a place to live.

## ACADEMIC LEARNING COMMUNITIES

[housing.uoguelph.ca/alc](https://housing.uoguelph.ca/alc)

Looking for an academically **enriched** residence experience? Want to live, learn and interact with other students in your program? Interested in **guidance** from an upper-year student who has previously been in your position? Choose an Academic Cluster.

### Benefits of living in an Academic Learning Cluster:

- Cluster leaders provide support and advice
- Go to class, study and socialize with neighbours
- Participate in organized academic and social events
- Improve your academic performance and have fun!

*Clusters are available for every program and have approximately 50 students per community. Locations vary year-to-year and are not available in to applicants in advance of applying.*

## LIVING LEARNING COMMUNITIES

[housing.uoguelph.ca/lc](https://housing.uoguelph.ca/lc)

Living in an LLC is an exciting way to **connect** with a tight-knit group of **like-minded** individuals. If being part of a small group with a big sense of community interests you, our Living Learning Communities are for you! LLCs are open to all students interested in self-discovery and expanding their knowledge and understanding of the world we share.

### Arts House

**Expand** your creative interests and talents.

### Eco House

**Engage** in a lifestyle dedicated to a healthy and sustainable environment.

### Indigenous House

**Explore** Indigenous ways of knowing, being, and doing by learning about First Nations, Inuit, and Métis peoples and cultures.

### International House

**Live** with Canadian and International students, sharing global cultures, languages, politics and much more.

### La Maison Française

**Immerse** yourself in French language and culture.

*LLCs are interest-based and are open to students in any program.*

## THEMED LEARNING COMMUNITIES

[housing.uoguelph.ca/tlc](https://housing.uoguelph.ca/tlc)

TLCs are unique areas in residence where students have requested to live with other students with **similar preferences**, to create a supportive and inspiring residence environment.

### Study Intensive Area

Located in our North and East Village communities, our Study Intensive Areas offer extended quiet hours and a study-focused environment.

### Substance-Free Area

Located in East Residence, students who request a substance-free living environment will be assigned with suitemates who have also indicated this preference.

### Varsity Athlete Area

Located in South Residence, students who are varsity athletes may request this residence community through their coach, allowing them to share space with others on a similar schedule.

**STUDENTS LIVING IN A RESIDENCE LEARNING COMMUNITY PERFORM, ON AVERAGE**

**3%**

**HIGHER**

**IN THEIR FIRST SEMESTER\***

\*Hobbins et al. (2017) "Do Students Who Live in Residence Learning Communities Perform Better Academically than Those Who Live in Traditional Residence and Off-Campus?"; Discussions on University Science Teaching: Proceedings of the Western Conference on Science Education: Vol. 1 : Iss. 1 , Article 7.

# RESIDENCE LEARNING COMMUNITIES

Learning Community	Campus Area	Style <sup>1</sup>	Co-Ed <sup>2</sup>	Spaces <sup>3</sup>	Room Types <sup>3</sup>
Arts House	North	Traditional	Co-ed	50	2
Indigenous House	East	Suite	Co-ed	35	1 2
International House	East	Suite	Co-ed	35	1 2
Eco House	East	Suite	Co-ed	27	1 2
La Maison Française	East	Suite	Co-ed	35	1 2
Study Intensive	North	Traditional	Co-ed	35	1 2
Study Intensive	East Village	Townhouse	Co-ed	35	1
Substance Free	East	Suite	Co-ed	15-30	1 2
Academic Clusters	All Areas	Variable	Co-ed	850	1 2 3

Room Types:      1 = Single      2 = Double      3 = Triple

**Notes:**

1. A traditional residence consists of a student room, with shared community washroom, kitchenette and common space. A suite consists of a single or double bedroom with shared bathroom and full kitchen (East) with microwave (Lambton) or full stove (East), sink and fridge.
2. Single-gender, gender-neutral and co-ed areas can be assigned within a residence community.
3. Building capacity and room types are subject to change from year to year based on occupancy needs.

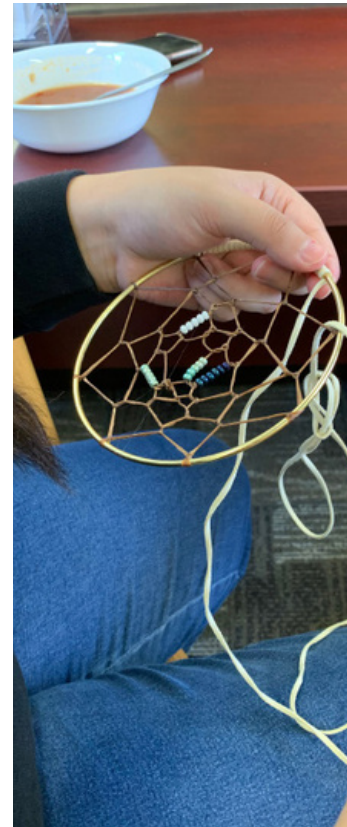

## To apply for a Residence Learning Community (RLC):

On your Residence Application, you will be asked to select and rank your preferences for up to five residence communities. The RLC options are all listed as residence options, and you may select more than one.

Be sure to consider what's most important to you - the RLC, the building location, or the room type. If your desire to live in an RLC is higher than your desire for another building, rank it accordingly.





# ACCESSIBILITY REQUESTS

*[housing.uoguelph.ca/accommodation](https://housing.uoguelph.ca/accommodation)*

**Do you have unique circumstances that require an accommodation?**

Additional consideration can be made in the room assignment process for students who require accommodations for medical, cultural/religious, mental health, or other personal reasons. The Accessibility Accommodation Form, which must be completed by an attesting professional, is due at the same time as your application on June 1, 2023.

The Accessibility Accommodation Form is embedded within your residence application. More details can be found on our website or by contacting the Residence Admissions team.



# ROOMMATES & SUITEMATES

[housing.uoguelph.ca/roommate](https://housing.uoguelph.ca/roommate)

We think it's important for you to be comfortable living in a multi-occupancy room, suite or townhouse. Living with your peers provides opportunities to socialize and meet new people while creating a campus culture that is unique to the University of Guelph.

**We have options for everyone, whether you have a preferred roommate or are ready to be matched with someone new!**

## I have a roommate in mind I would like to live with

You are invited to add a preferred roommate to your residence application after the June 1 deadline, provided you have both completed an on-time residence application and deposit. You can add 1 or 2 roommates in traditional residence, or up to 5 suitemates for our East Residence or East Village townhouses. You will be contacted to complete this process in mid-June.

## I would like to be assigned a roommate at random

Many lifelong friendships begin in residence with someone you've never met before! On your Residence Application, we will ask you some questions about yourself that will help us to get to know you a little better so that we can try to find a match. It's important for you to be honest when you answer these questions to avoid potential future conflict.

## I would only like a single room

Although the University of Guelph has over 2,000 single rooms available to first-year students, your assignment location is not guaranteed. We use a lottery process to complete room assignments and encourage variety in your application should your first choice be unavailable.

**WHO**  
you live with  
is just as  
important as  
**WHERE**  
you live.





# HOW TO APPLY

*[housing.uoguelph.ca/apply](https://housing.uoguelph.ca/apply)*

We make applying to residence easy!

## **1) Visit our website**

[housing.uoguelph.ca/apply](https://housing.uoguelph.ca/apply) has step-by-step instructions and a helpful walkthrough video to explain the process.

## **2) Browse our residences**

Look through the different residences offered, including academic and living learning communities to decide your preferences for the application.

## **3) Enter the Housing Portal**

This is where you will find the application and your user profile. Follow the prompts and fill out all the necessary information.

## **4) Submit your application**

You will receive a confirmation email\* if submitted successfully.

## **5) Pay the \$750 deposit**

Using online banking (domestic applicants) or credit card (international applicants) before the June 1, 2023 deadline.

**NOTE: Your application is not complete until the Application AND the Residence Deposit are received.**

\*all official communication from Student Housing Services will be sent to your GryphMail (@uoguelph.ca) email account.

# LET'S EAT!

[hospitality.uoguelph.ca](http://hospitality.uoguelph.ca)

At U of G, we understand that food is an essential part of your on-campus living experience.

A meal plan is required in all traditional residences, including our North and South communities. In the East Towers and East Village Townhouses, a meal plan is optional due to full kitchen access.

Meal Plans are available in different sizes to match your preferences and lifestyle. Your choice must be indicated in your residence application.

To learn more about dining on campus and meal plan rates, visit the Hospitality Services website.

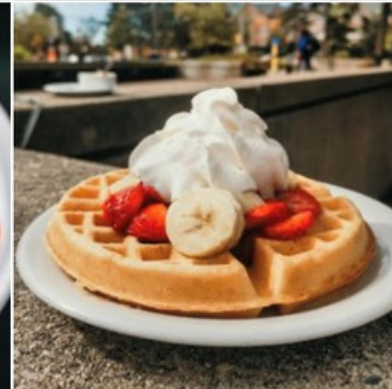

## WE'RE RANKED

# #1 IN CANADA

For University Food Services for over 10 years!\*

\*Maclean's Magazine University Rankings

## RESIDENCE FEES

[housing.uoguelph.ca/fees](http://housing.uoguelph.ca/fees)

The fees listed here include a \$750 residence deposit, which is applied to the Winter semester fees.

Residence fees are due each semester at the same time as tuition and other University of Guelph student fees.

Room Type	Campus Area	Total*
Single	North & South	\$8,547
Single	Johnston Hall	\$8,671
Single	East Towers	\$8,925
Single	Lambton Suite	\$8,925
Single	East Village	\$9,517
Double	North, South & Village	\$7,324
Double	Johnston Hall	\$7,421
Double	East Towers	\$7,930
Triple	North & South	\$6,799
Quad	North & South	\$6,520

\*Note: The rates and rate structures quoted above are subject to change and are based on the 2022/2023 academic year. Please check our website for the updated Fall 2023/Winter 2024 fees.

# EAST

4 East Towers:  
Dundas, Lanark and Glengarry

5 East Village Townhouses



# NORTH

6 Arts House

7 Johnston

8 Mills

9 Lambton

10 Lennox & Addington

11 Watson



3

2

1

Rozanski Hall Classrooms

MacKinnon Building Classrooms

McLaughlin Library

University Centre

Summerlee Science Complex

Johnston Green

8

War Memorial Hall



## WEST RESIDENCE

[housing.uoguelph.ca/west](https://housing.uoguelph.ca/west)

Designed for graduate and mature undergraduate students, West Residence offers independent living in 3-person townhouses. Learn more on our website.

# LET'S CONNECT

**Website** | [housing.uoguelph.ca](https://housing.uoguelph.ca)

Information about living on campus, room tours, live chat, residence life information, and more.

**Email** | [housing@uoguelph.ca](mailto:housing@uoguelph.ca)

For general questions and inquiries to the Housing Admissions team.

**Phone** | **(519) 824-4120 ext. 58701**

Available Monday to Friday, 8:30 AM to 4:30 PM.

**Social** | [@UofGHousing](https://www.instagram.com/UofGHousing)    

Updates from residence, event information, content from a student perspective, contests, and more.



IMPROVE LIFE.

**Student Housing Services**

Maritime Hall  
50 Stone Road East, Guelph,  
Ontario, Canada, N1G 2W1

[housing.uoguelph.ca](https://housing.uoguelph.ca)